



Motorized folding machines SLF

SLF, SLF S, SLF SH, SLF 3SH

Motorized folding machines of the SLF type cover a wide range of applications in the production of both simple and complex products up to a length of 4m.

Eccentric drive of the clamping beam provides the maximum speed and the desired contact force. When you open it, then it is up to 140mm.

Opening the clamping beam simultaneously with the return movement of the folding beam shortens the time-cycle of the machine.

The folding beam is equipped with a crowning system bar, which allows to achieve the required accuracy over the entire length of the bend.

The appropriate choice of the control system, back gauges, and other accessories creates the conditions for the optimal cost equipment and rapid return on investment.

The machines find application in construction, furniture industry, in the manufacture of doors, billboards, in air conditioners, in the manufacture of switchboards, and the like.

STANDARD EQUIPMENT:

- tools according type of machines (page 9)
- manual adjustment of one folding angle, type MA (page 21)
- manual crowning adjustment for folding beam
- foot switch
- 3x400V, 5 meter cable

SPECIAL EQUIPMENT:

- potentiometer for adjustment angle PT1 (page 21)
- touch control system NT1 (page 21)
- touch control system NT3 (page 22) or FF-101 (page 23) with motorized back gauge 1000mm (page 25)
- touch control system FF-101 (page 23) with motorized back gauge for shape U, J, L and T (page 26)
- balls for back gauge
- squaring arm on right or left side for back gauge
- extension of back gauge (1500, 2000, 2500, 3000mm)
- manual back gauge MOD, MPD (page 25)
- blades and segments for stainless steel
- special shapes of blades and segments
- quick change segments
- marking segments with width in mm
- safety wire barrier
- extra foot switch (for 2. operator)
- tool cart
- power supply 3x230V
- customer colours
- welded frame for transport

For **SLF** folding machines we recommend:
Motorized shears **MPS**

TECHNICAL PARAMETERS

Model	Working length mm	Max. sheet thickness steel 400N/mm ² mm	Max. sheet thickness stainless 600N/mm ² mm	Max. sheet thickness aluminium 275N/mm ² mm	Opening blade/segment mm	Motor of clamp./ folding beam kW	Length mm	Width mm	Height mm	Weight kg	
SLF, SLF S SLF SH, SLF 3SH	10/35	1020	3,50	2,00*	5,00	140	0,75/1,1	1950	800	1200	1360
	12/30	1270	3,00	1,75*	4,50	140	0,75/1,1	2200	800	1200	1470
	15/30	1520	3,00	1,75*	4,50	140	0,75/1,1	2450	800	1200	1580
	20/25	2020	2,50	1,50*	4,00	140	0,75/1,1	2950	800	1200	1760
	25/20	2520	2,00	1,25*	3,00	140	0,75/1,1	3450	800	1200	1920
	30/15	3020	1,50	1,00*	2,00	140	0,75/1,1	3950	800	1200	2200
	40/10	4020	1,00	0,60*	1,50	140	0,75/1,1	4450	800	1200	2850

* for stainless steel folding is needed to order hardened tools for stainless

SLF STANDARD TOOLS

SLF, SLF S, SLF SH, SLF 3SH

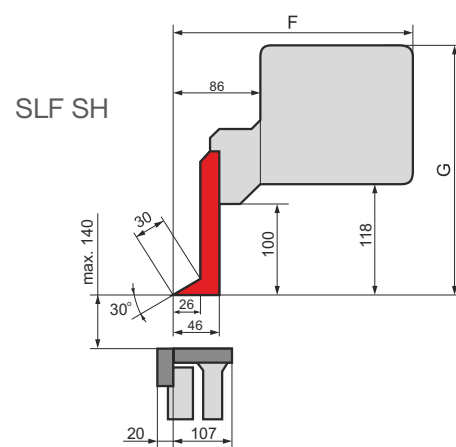
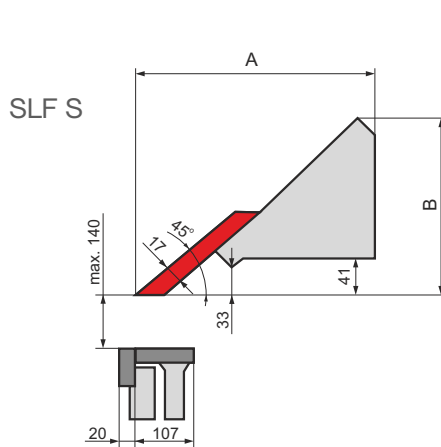
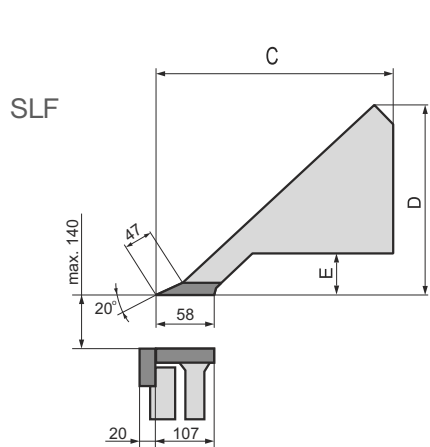

Work. length	C	D	E
1000	380	338	52
1250	380	338	52
1500	380	338	52
2000	360	338	52
2500	360	338	52
3000	360	338	52
4000	360*	338*	52*

Dimensions of the beams are in mm

Work. length	A	B
1000	350	310
1250	350	310
1500	350	310
2000	350	310
2500	355	315
3000	355	315
4000	355*	315*

Dimensions of the beams are in mm

Work. length	F	G
1000	270	300
1250	270	300
1500	290	320
2000	290	320
2500	310	340
3000	310	340
4000	310*	306*

Dimensions of the beams are in mm

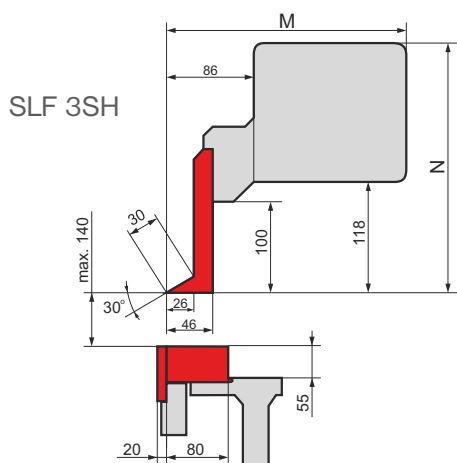

Work. length	M	N
1000	270	300
1250	270	300
1500	290	320
2000	290	326
2500	310	340
3000	310	340
4000	310*	340*

Dimensions of the beams are in mm

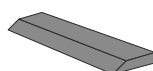

Gray tools - blades

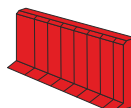

Red tools - segments (divided blade)

Other shapes and dimensions of tools consult the manufacturer. *Dimensions are informative