



## Motorized folding machines SFM

SFM, SFM 3S

Motorized folding machines class SFM of solid welded construction are used to make square ventilation pipes and L-profiles with a TDC or TDF flange type. The maximum height of the flange is 35mm. The stop bar allows making the precise alignment of the position before folding the sheet metal of different lengths, which facilitates operation by one person.

The SFM folding machines offer the following designs:

- SFM • clamping blade is solid, folding and the bed blade are segmented
- SFM 3S • clamping bending and bed blades are segmented

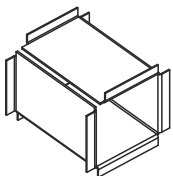

Duct for TDC connection

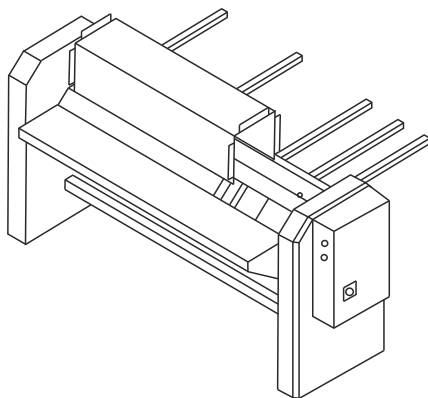

### STANDARD EQUIPMENT:

- blade of the clamping beam 80° or segments
- bed and folding segments
- front support table
- manual adjustment of one folding angle, type MA (page 21)
- foot switch
- 3x400V, 5 meter cable

### SPECIAL EQUIPMENT:

- potentiometer for adjustment angle PT1 (page 21)
- touch control system NT1 (page 21)
- touch control system NT3 (page 22) with motorized back gauge 1000mm (page 25)
- balls for back gauge
- squaring arm on right or left side for back gauge
- extension of back gauge (1500, 2000, 2500, 3000mm)
- manual back gauge MOD, MPD (page 25)
- blades and segments for stainless steel
- special shapes of blades and segments
- quick change segments
- marking segments with width in mm
- safety wire barrier
- extra foot switch (for 2. operator)
- tool cart
- power supply 3x230V
- customer colours
- welded frame for transport

For SFM folding machines we recommend:  
Motorized shears MPS

### TECHNICAL PARAMETERS

Model	Working length mm	Max. sheet thickness steel 400N/mm <sup>2</sup> mm	Max. sheet thickness stainless 600N/mm <sup>2</sup> mm	Max. sheet thickness aluminium 275N/mm <sup>2</sup> mm	Opening blade/segment mm	Motor of clamp./ folding beam kW	Length mm	Width mm	Height mm	Weight kg	
SFM SFM 3S	20/15	2020	1,50	1,10*	2,50	180x180	0,37/0,75	2760	810	1160	1580
	25/15	2520	1,50	1,10*	2,50	220x220	0,75/1,1	3240	825	1180	1820
	30/15	3020	1,50	1,10*	2,50	250x250	0,75/1,1	3740	825	1180	2070

\* for stainless steel folding is needed to order hardened tools for stainless

# SFM STANDARD TOOLS

SFM, SFM 3S

## SFM

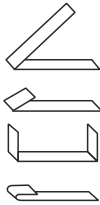
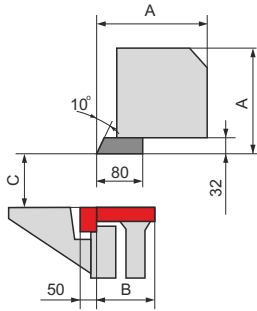

Work. length	A	B	C
2000	170	70	100
2500	220	80	140
3000	220	80	140

Dimensions of the beams are in mm

## SFM 3S

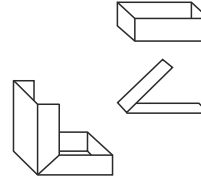
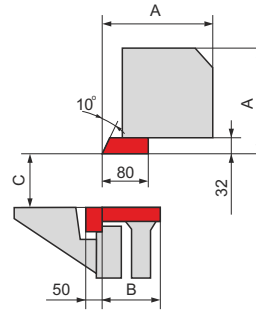

Work. length	A	B	C
2000	170	70	100
2500	220	80	140
3000	220	80	140

Dimensions of the beams are in mm

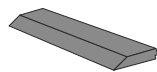

Gray tools - blades

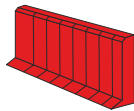

Red tools - segments (divided blade)

Other shapes and dimensions of tools consult the manufacturer. \*Dimensions are informative